

### Eureka FLOAT 3-Way Corner Connectors

| Item Description                         | Part#         |
|------------------------------------------|---------------|
| 3 Way Corner A Side, Matte Black         | 086-ZIZXE-MB  |
| 3 Way Corner B Side, Matte Black         | 086-ZZZXE-MB  |
| 3 Way Corner A Side w/ Adjust. Foot      | 086-ZIOZXE-MB |
| 3 Way Corner B Side w/ Adjust. Foot      | 086-Z2OZXE-MB |
| Extra Screws for Connectors, Matte Black | OFE-AMXXI-MB  |

- Corners are not directionally specific. Use 1 of each type (A/B) at each ends of bar that connects in between. See assembly examples for further direction.
- Screws are included with Corner Connectors. Extras intended for spares.

### Basic Assembly with 3-Way Corner Connectors

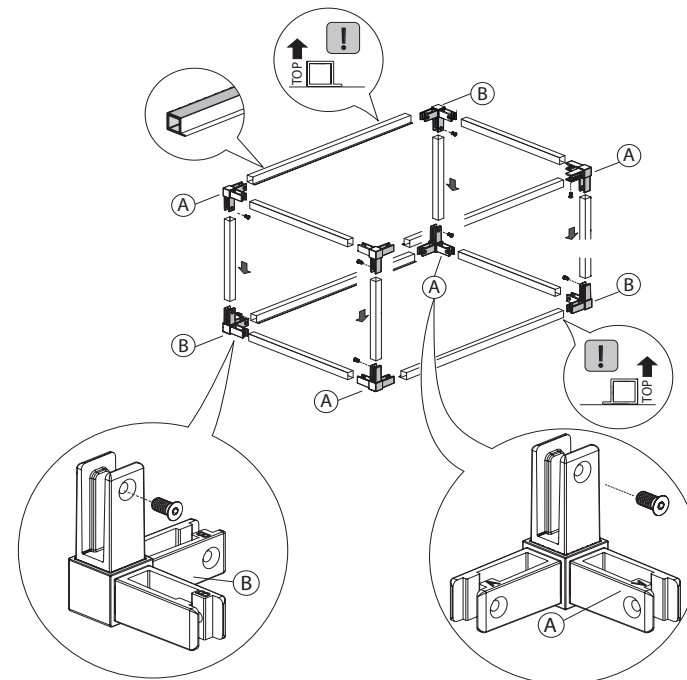

### Recommendation for Calculating Outside Dimensions

