

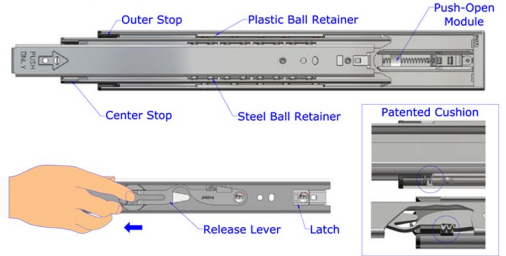

### Features

- Push-Rebound function built in slide
- Rebounds 2" - 5" when drawer is pushed
- Non handed disconnect release
- Zinc plated with clear epoxy
- Only 2mm required to push in for open or close
- 12.5mm (1/2") side spacing
- Load rating 45kg (100 lbs.) at 20"



### Drawer Slide Mounting Profile

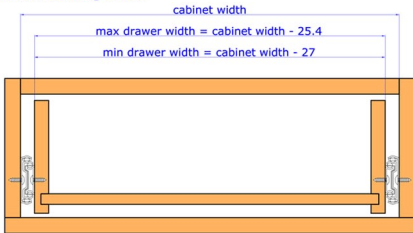

\* max drawer width = slide length + 200 (mm)

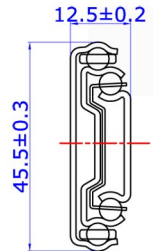
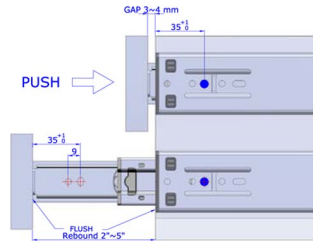

### Slide Dimensions

All Dimensions are in Millimeters (mm)

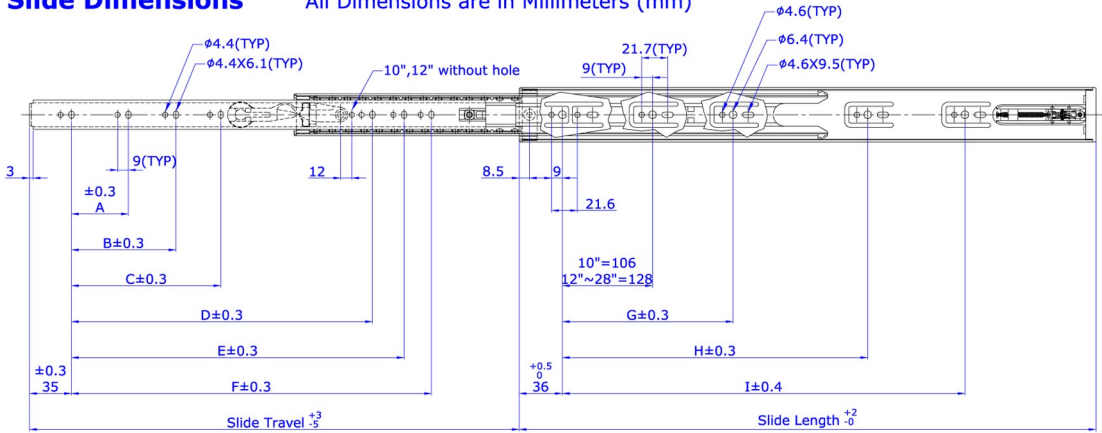

Part Number	SIZE	Slide Length	Slide Travel	Load Rating/Kg	A	B	C	D	E	F	G	H	I	Pack
371-GS4260-12EZP	12" (300)	300	305	25						200				10 Pr.
371-GS4260-14EZP	14" (350)	350	356	35	96					256	192			10 Pr.
371-GS4260-16EZP	16" (400)	400	406	40	128					294	224			10 Pr.
371-GS4260-18EZP	18" (450)	450	457	45	96	160				344	288			10 Pr.
371-GS4260-20EZP	20" (500)	500	508	45	96	160	352			394	224	352		10 Pr.
371-GS4260-22EZP	22" (550)	550	559	40	128	192	384			444	224	352		10 Pr.
371-GS4260-24EZP	24" (600)	600	610	40	128	224	416			494	224	352	448	10 Pr.
371-GS4260-26EZP	26" (650)	650	660	35	128	224	416	480		544	224	352	480	10 Pr.
371-GS4260-28EZP	28" (700)	700	711	35	128	224	288	480	544	594	224	352	544	10 Pr.