



Carrione Knob Satin Nickel

Part Number: A36647MWG10



From the winding bed of Italy's Carrione River comes the coveted Carrara marble. Crafted by hand and balancing timeless beauty with clean contemporary style, this Carrara-inspired look takes new form in Amerock's Carrione™ collection.

Colour Group	Silver
Finish Code	Satin Nickel, Marble White
Material	Marble / Zinc
Overall Length	64 mm
Projection (Height)	40 mm
Type	Knob

Product Description

From the winding bed of Italy's Carrione River comes the coveted Carrara marble. Crafted by hand and balancing timeless beauty with clean contemporary style, this Carrar-inspired look takes new form in Amerock's Carrione™ collection.

Amerock offers a complete line of decorative and functional cabinet hardware, bath hardware, hook and rail and wall plates. Amerock's award-winning decorative and functional hardware solutions have built the company's reputation for chic design accessories that inspire homeowners to express their personal style. Available in a variety of finishes and styles, Amerock offers high quality designs at affordable prices to create the perfect finishing touch for any room.

Product Advantages

- Intricately crafted with precise detail for lifelong beauty and durability
- Includes mounting hardware: (Size(s):#8-32 x 1in Truss Head Machine Screw)
- Complete with Amerock Guardian Lifetime Guarantee against defect in material and workmanship

Included Products

Industry standard mounting hardware



Technical Documents

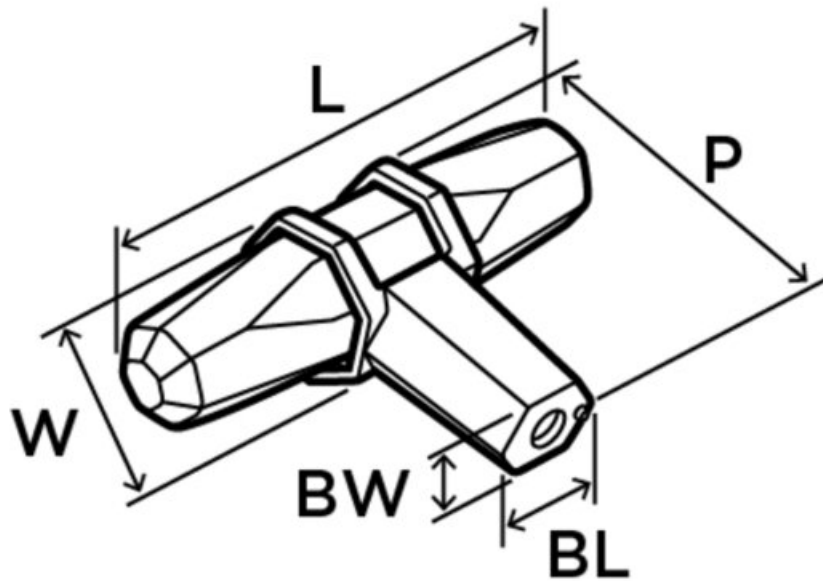

L (Length) = 2-1/2in(64mm)

W (Width) = 13/16in(21mm)

P (Projection) = 1-9/16in(40mm)

BL (Base Length) = 9/16in(14mm)

BW (Base Width) = 3/8in(10mm)

Profile# 36647

View this product online at <https://marathonhardware.com/pd/A36647MWG10>



Technical Documents

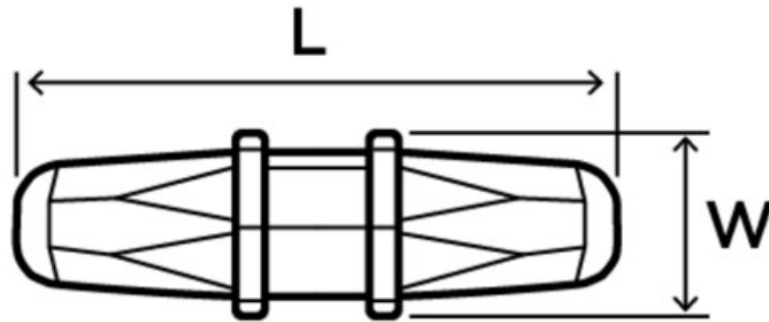

L (Length) = 2-1/2in(64mm)

W (Width) = 13/16in(21mm)

Profile# 36647

View this product online at <https://marathonhardware.com/pd/A36647MWG10>

